

Bedford Closelt® M1



Closing Bags

NOTE: Twisting the bag before entering the machine allows for smoother clip application.

1. Grab the open end of the bag with one hand and the product area with the other.
2. Leading with your top hand, push the bag into the closing area.
3. Remove the bag by pulling back equally with both hands. The removal of the bag will pull the next clip into position and disconnect the clip applied to the bag.

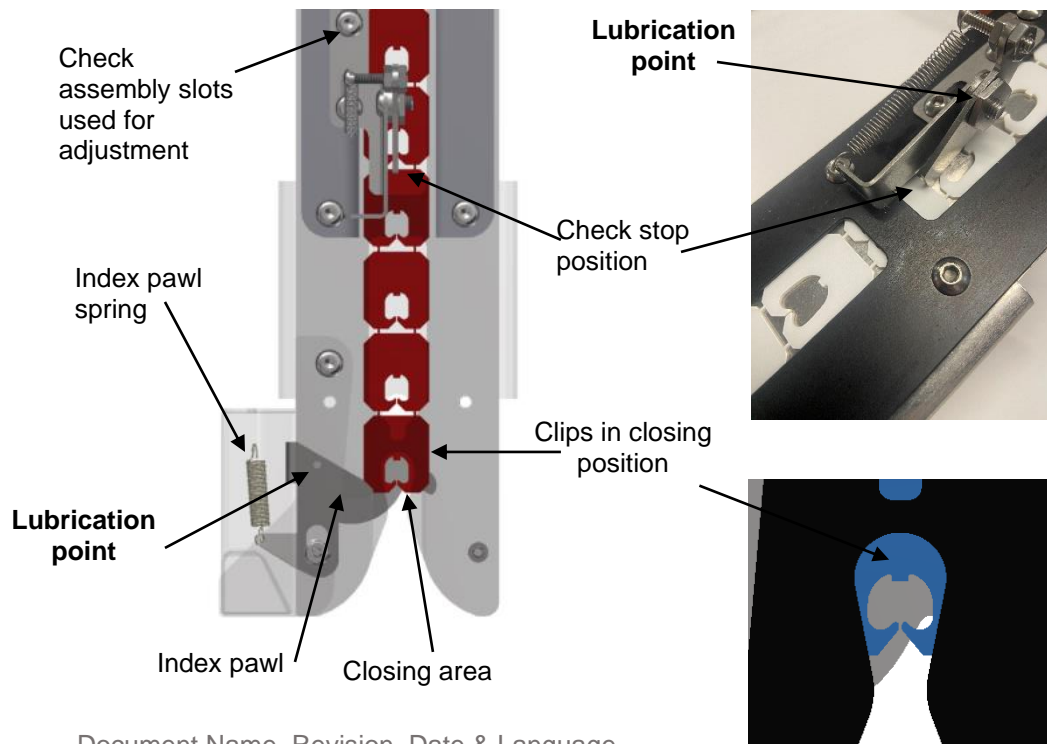

Check Spring Adjustment

The check assembly is used to hold the clip in the correct position when the bag enters the closing area. The check should be positioned so the clips stop when the bag is inserted. The latch of the check will be close to the front the "V" slot. The check assembly should rotate freely as clips pass.

Maintenance

The index pawl and check stop pivot should be lubricated **weekly** for smooth operation. In the figure, there is a lubrication point where a few drops of oil can be added.

Use a lightweight food grade mineral oil (NSF registered, H1 grade) or similar. CRC and LPS brands offer a variety of products for facilities with food safety plans.

NOTE: If customer has additional facility food safety plan or local law requirements, they will need to confirm oil used meets those requirements.

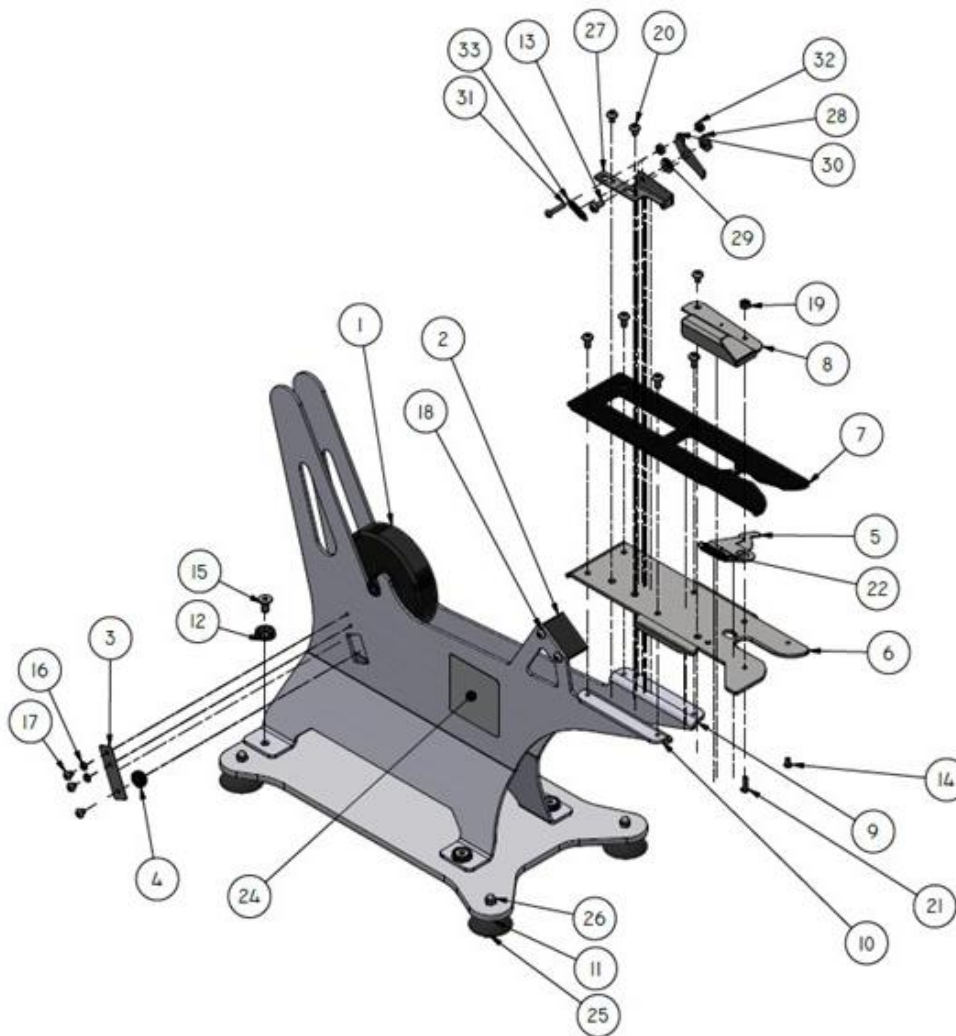

ITEM	QTY	PART NUMBER	DESCRIPTION
1	1	2018006100	Hub
2	1	2018006101	Block, Guide
3	2	2018006106	Spring, Brake
4	2	2018006107	Pad, Brake
5	1	2018006105	Pawl, Index
6	1	2018006104	Plate, Track Base
7	1	2018006204	Track
8	1	2018006205	Cover, Pawl Spring
9	1	2018006202	Frame, Side Left
10	1	2018006201	Frame, Side Right
11	1	2018006203	Plate, Base
12	4	52-95481A035	Washer, Countersink 1/4"
13	5	52-103238BHSS	Button head, SS, 10-32X3/8
14	1	52-63214BHSS	Button head, SS, 6-32X1/4
15	4	52-142812FHSS	Flat head, SS, 1/4-28 X 1/2
16	4	52-8LWSS	Lock washer, SS, #8
17	6	52-832316BHSS	Button head, SS, 8-32 X 3/16
18	2	52-102438BHSS	Button head, SS, 10-24X3/8
19	1	52-632LNSS	Lock nut, SS, 6-32
20	3	52-103214BHSS	Button head, SS, 10-32X1/4
21	1	52-63212BHSS	Button head, SS, 6-32X 1/2
22	1	52-LE-022C-06-M	Spring Ext, Index Pawl
24	2	2018006213	Label, M1
25	4	52-53535A23	Rubber foot
26	4	52-832CNSS	Cap nut, SS, 8-32
27	1	20180031085	Mount, Check
28	1	27381090	Pivot, Check
29	1	27381089	Washer, Check
30	1	27381088	Check, Clip
31	1	52-63234BHSS	Button head, SS,6-32X3/4
32	2	52-632NSS	Nut, SS, 6-32
33	1	52-94135K741	Spring Ext, SS, Check Assembly